

## WARNING

No matter where you are in the world, the water you drink can make you sick. Use good judgment and be cautious. Read and understand the H2gO Purifier instructions. Knowing how to effectively use this product will increase your chances of creating safe drinking water.

- This product makes an oxidant that is a eye and skin irritant. Know how to use it properly.
- Do not ingest undiluted oxidant.
- Do not mix the oxidant with acids or other chemicals.
- Undiluted oxidant will bleach your clothes if spilled on them.

**BE RESPONSIBLE.** Read these instructions carefully before use. Failure to follow these warnings and instructions may result in serious illness.

**CAUTION.** The H2gO Purifier creates a chemical oxidant that can irritate eyes and bleach clothing. Do not touch your eyes while using the purifier. Keep at least one foot away from your face and clothing during use. Rinse the H2gO Purifier and your hands after each use. Also see FIRST AID.

**CAUTION.** Do not add more water to the drinking container after treatment. Adding water after treatment increases the risk of contamination.

**CAUTION.** To prevent drinking any contaminated water, container threads must be treated in the same manner as the water in the container.

**FIRST AID.** If oxidant gets in eyes, remove contact lenses and rinse with plenty of water for 15 minutes. If undiluted oxidant is swallowed, drink large amounts of clean water. **DO NOT** induce vomiting. Call a physician or medic immediately. If oxidant comes in contact with skin, immediately remove contaminated clothing and wash skin thoroughly with water.

**NOTICE** This device uses a cell phone type re-chargeable lithium ion polymer battery that is sealed in the H2gO Purifier device. Follow precautions accordingly. Dispose of properly.

## TIPS

- The purifier will treat about 150 liters at standard dose before the battery needs to be recharged. Any micro USB charger will recharge the battery. 1 hour of solar exposure will add enough energy to treat about 2 liters at standard dose.
- If the brine bottle is lost, add a pinch of salt (about ½ gram or 1/16 tsp) to the cell chamber, add water to the chamber, and allow salt to dissolve before activating.
- Chlorine test strips are available to verify water quality. For details, refer to the web site.

## 1. MIX SALT WATER

Add salt up to the fill line in the supplied bottle, then add water up to the neck of the bottle. Shake to dissolve the salt. The 30 mL bottle now has enough volume to make about 10 batches of disinfectant.



## 2. ADD SALT WATER TO THE PURIFIER

Fill the reaction chamber with salt water.

*NOTE: If the salt water bottle is not available, a pinch of salt (roughly ½ gram or 1/16 tsp) can be added directly into the reaction chamber, followed by enough water to fill the chamber. Allow the salt to dissolve before operating the device.*

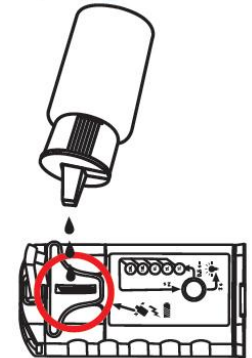

## 3. MAKE DISINFECTANT

Push the activation button to select the volume of water to treat. Press and hold (for about 2 seconds) until you see bubbling in the reaction chamber.

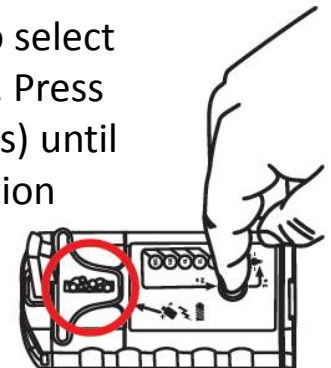

#### 4. ADD DISINFECTANT TO THE WATER

Once bubbling has stopped, pour the disinfectant into the water to be treated. If treating for Cryptosporidium and the water is cloudy or colored, add a second dose. Close the lid and shake thoroughly.



#### 5. DISINFECT LID

If drinking from the container, remove the lid and moisten the threads with treated water. Reattach the lid to the container.

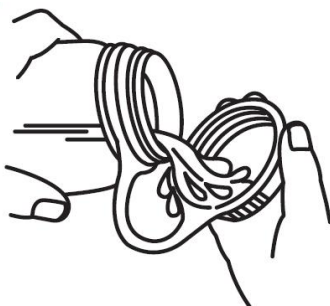

#### 6. WAIT BEFORE DRINKING

Wait 30 minutes for inactivation of bacteria, viruses, and Giardia, and a total of 4 hours from start for Cryptosporidium.



#### TROUBLESHOOTING



**Low Salt Water** – solid red light indicates salt concentration is too low. Fill cell chamber to brim with properly mixed salt water.



**Battery Charging Icon** – solid red light indicates battery charge is in process, either via USB or solar. Light will turn off when battery is fully charged.



**Low Battery Icon** – solid red light indicates that battery needs to be charged, either via USB or solar.

#### FLASHLIGHT

Press and hold the activation button for 3 seconds to turn on the flashlight. All other lights must first be off.



**H2GO Purifier PRIME Quick Start Guide**

**Capacity: 1, 2, 3, 5, 10 L**

**5 mg/L dose**